

A

FLEX

F57-SZF1DN/240/66

A	B	C	D	
1	F57-1028	2346,	659,	1/3
2	F57-1029	2346,	659,	1/3
3	F57-2034	967	660	3/3
4	F57-2035	967	660	3/3
5	F57-3045	929	658	3/3
6	F57-3046	929	638	3/3
7	F57-4001	2370	465	2/3
8	F57-4002	2370	60	2/3
9	F57-9310	1732	939	2/3
10	F57-9322	616	939	2/3
11	g47/28	925,	0	3/3

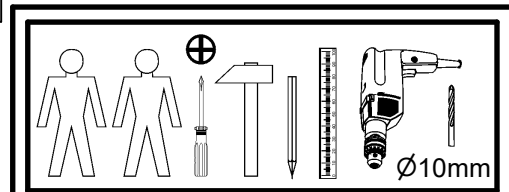
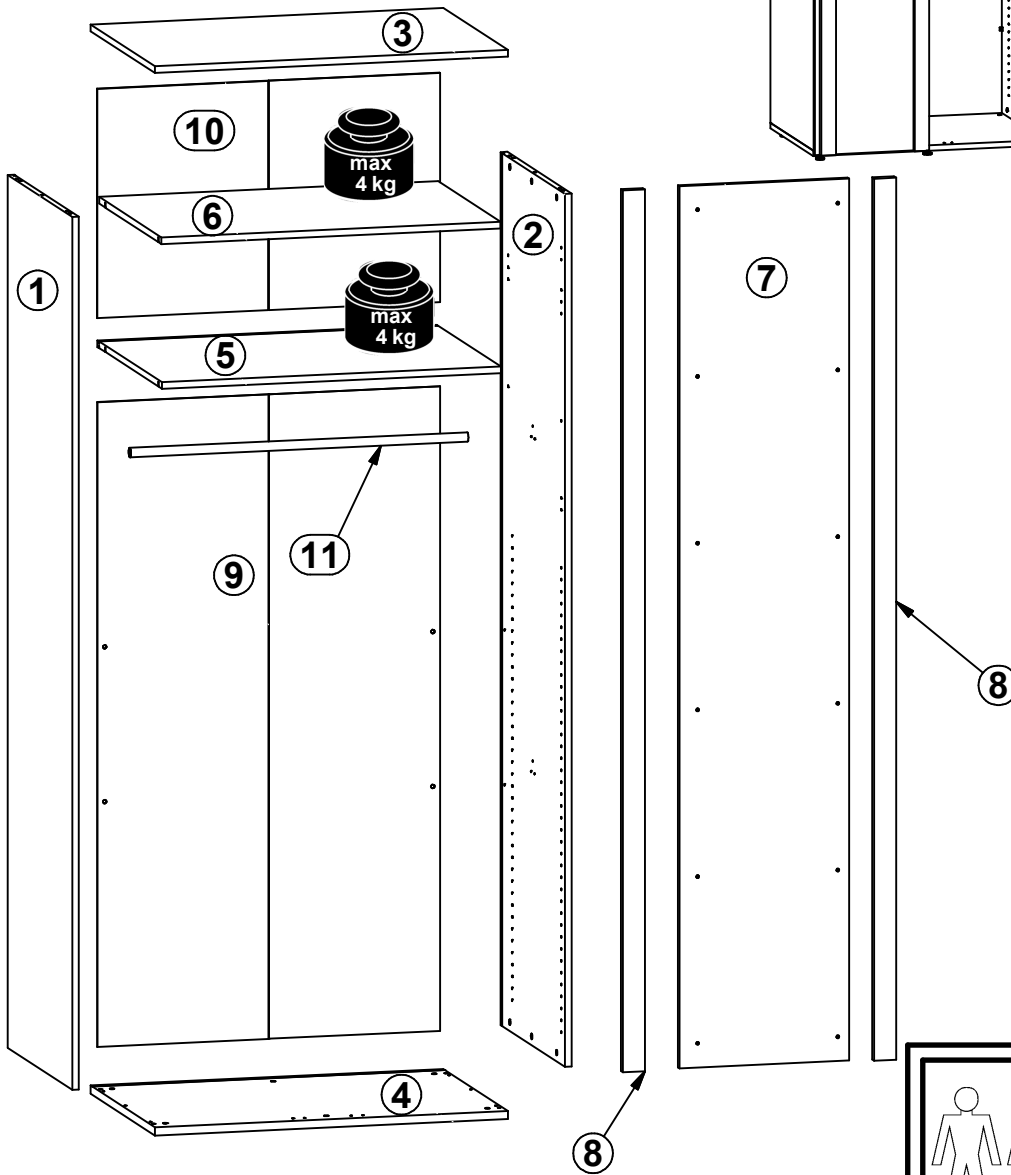
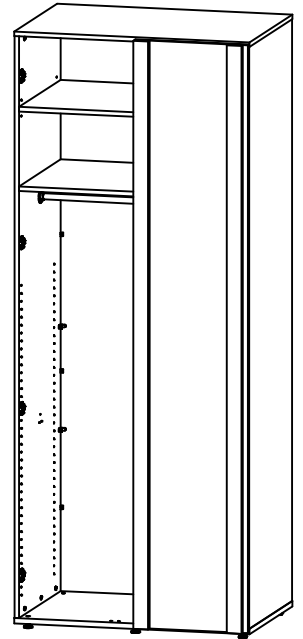
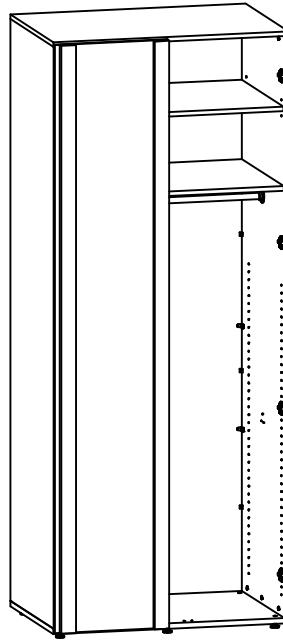
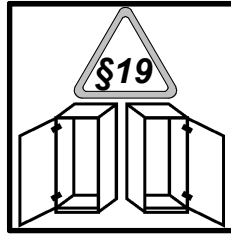

4x a204	4x b90	4x d20	24x e2 Ø6,3x13 mm	6x e3 Ø6x13 mm	12x e22 Ø7x28 mm	4x e50 Ø6,3x10 mm	8x f1 Ø8x30 mm	2x g46
6x k75/3 32 mm	12x l2	6x n32 50x50x50/1,5	8x p51 Ø3,5x15 mm	12x r1 Ø15x12 mm #16	8x r36 Ø20x12 mm #16	8x r37 6,7/7,8	12x r42 20/11	6x r66 Ø12xM10x17mm
12x s2 Ø16	4x s4 Ø5	6x s41 Ø12x4 mm	1x z15 4 mm	1x z22 3 mm	1x n14/2 88x21x15/1,5	2x p38 Ø3,5x16 mm	1x p17 Ø5x80 mm	1x f35 Ø10x50 mm

1 

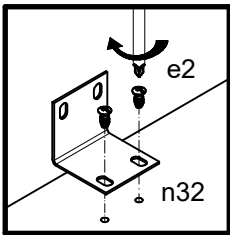
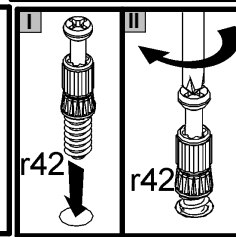
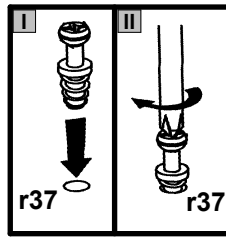
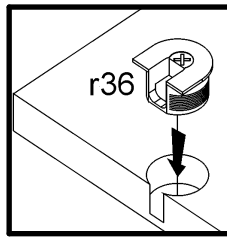
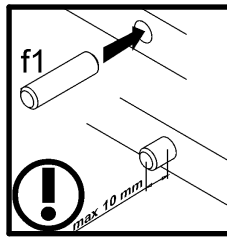
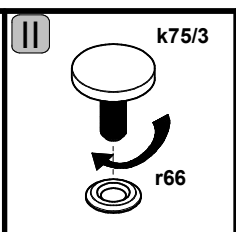
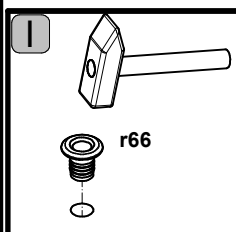
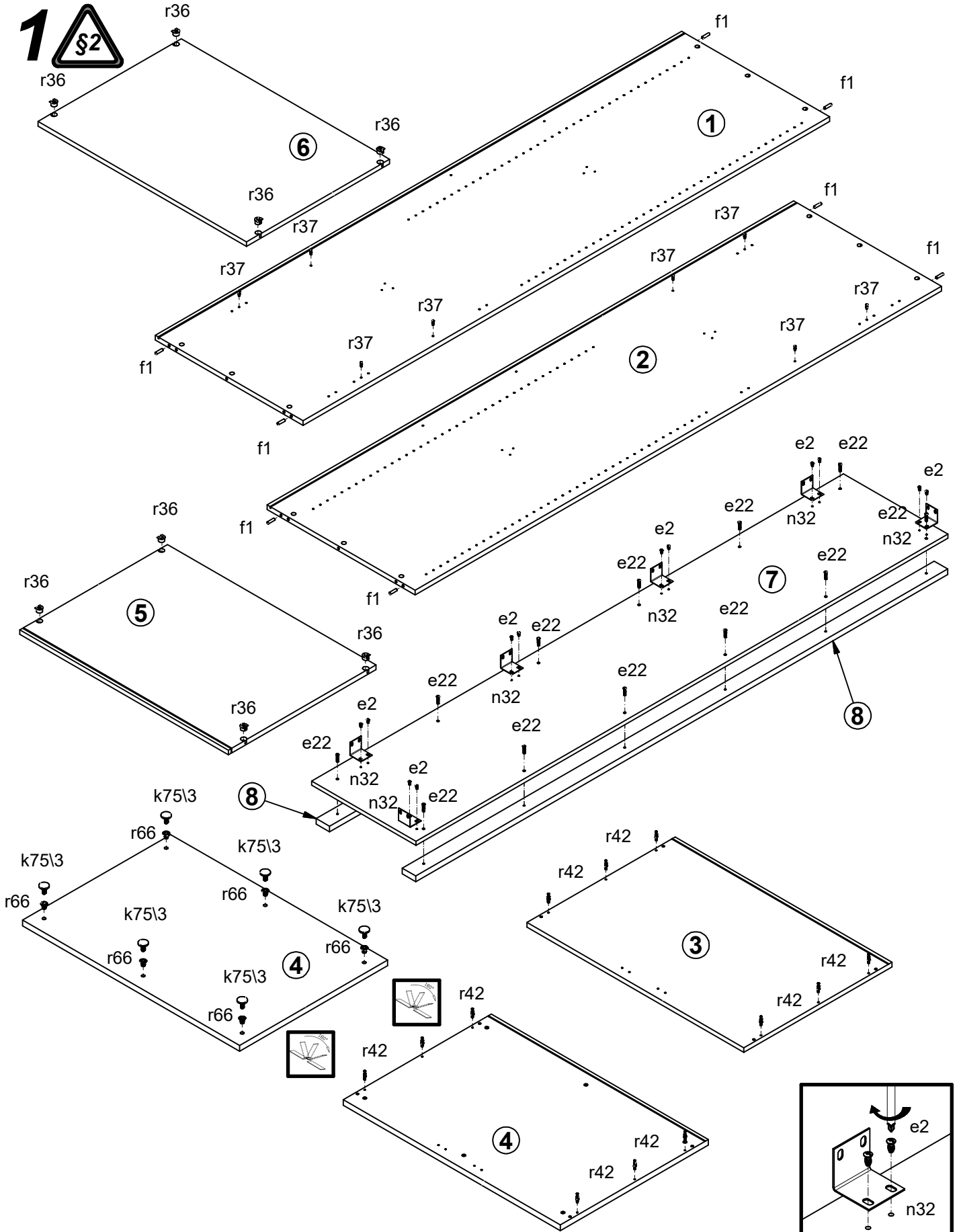

2



I

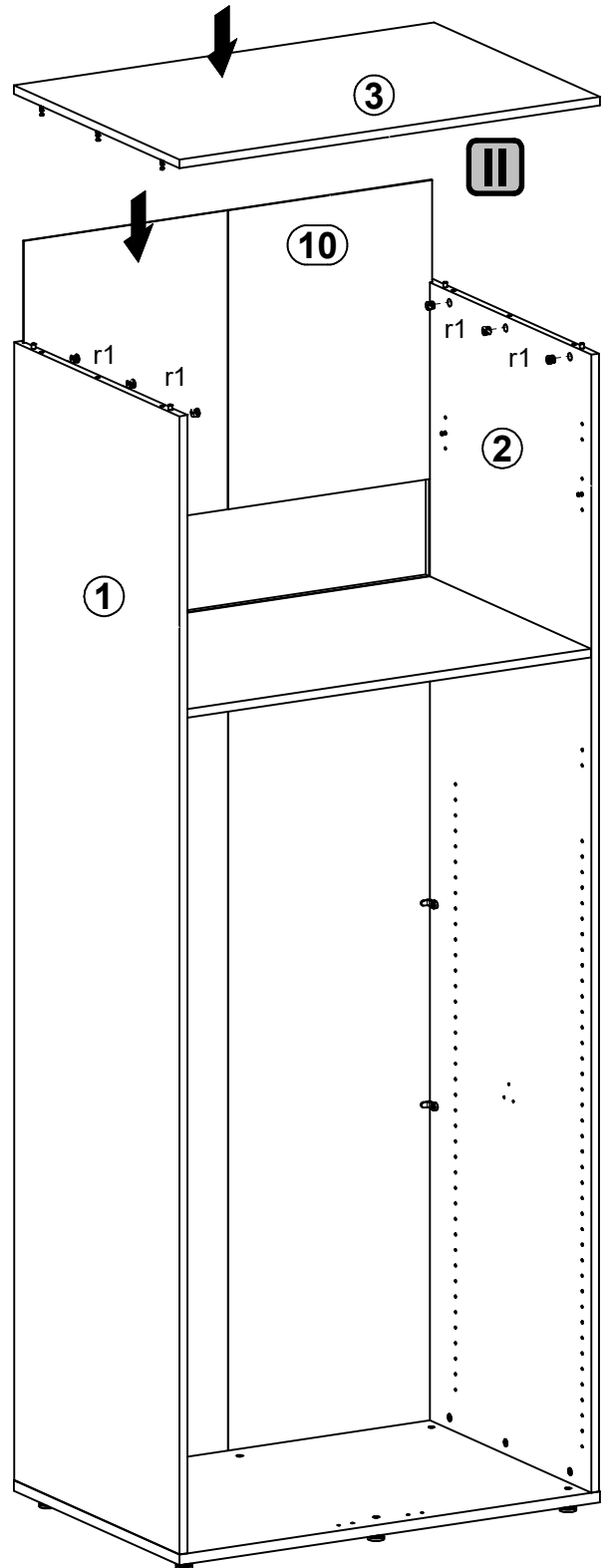
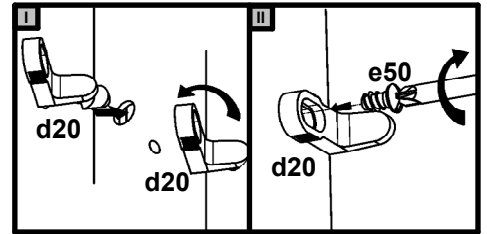
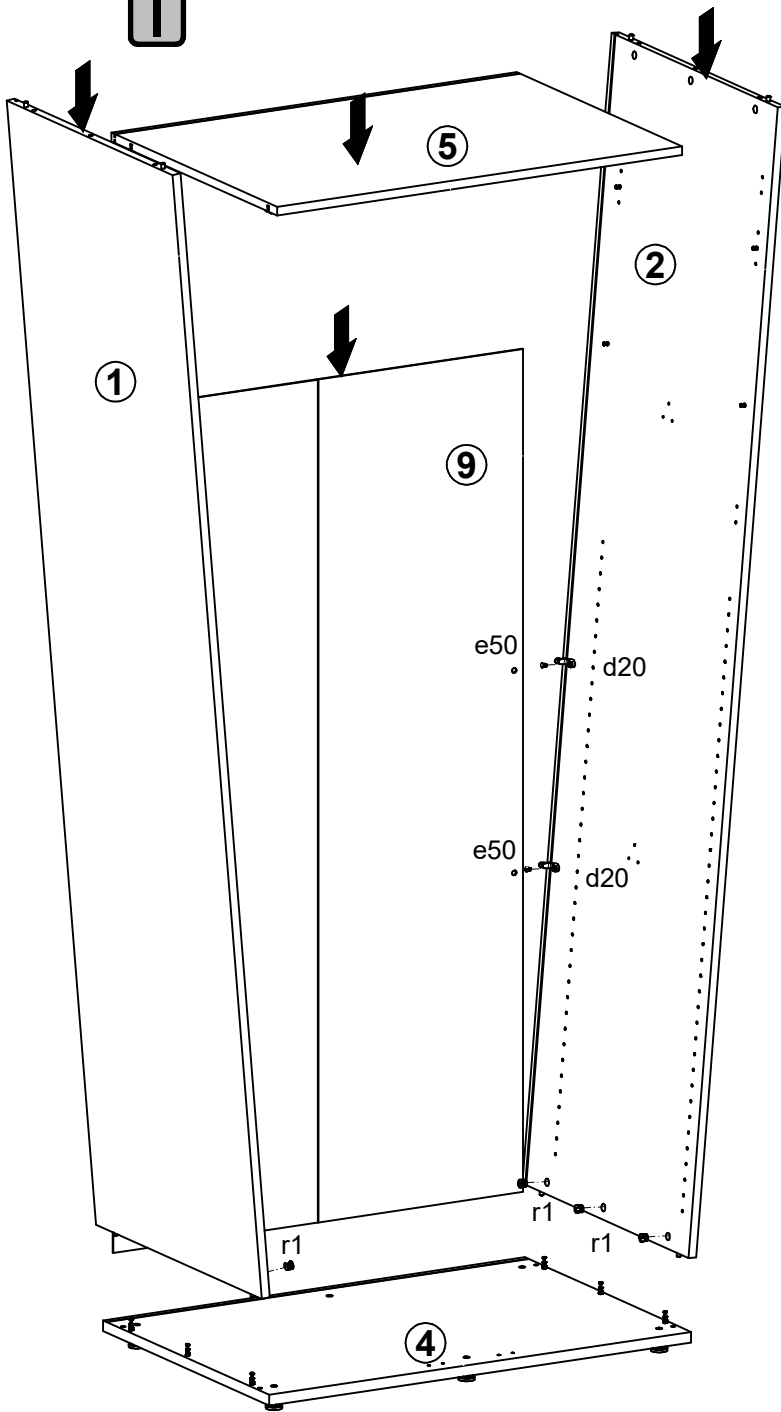

II

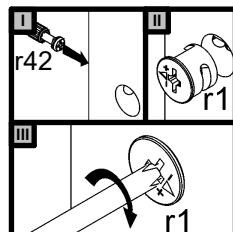
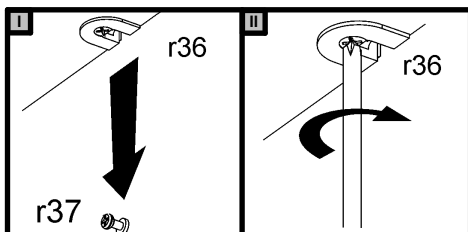

3

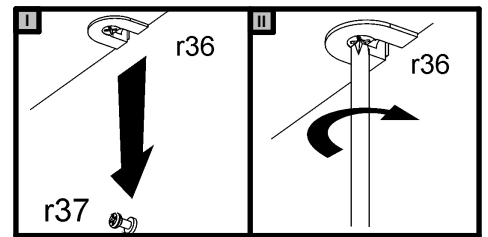
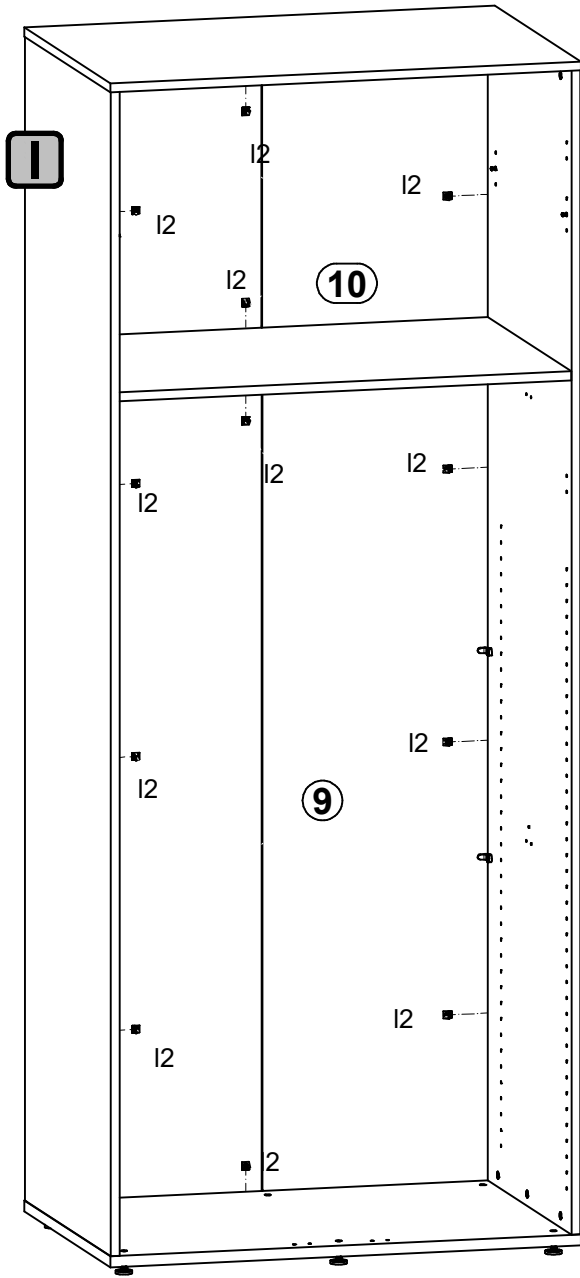
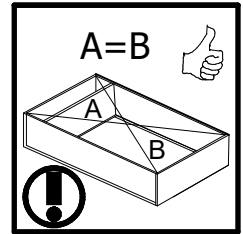
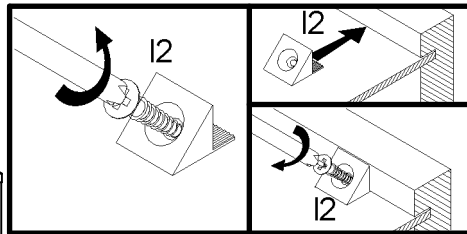

II

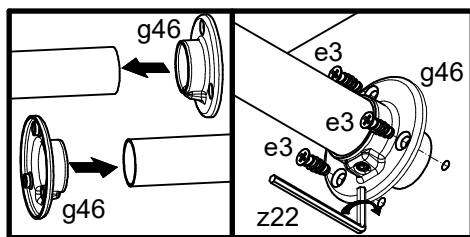
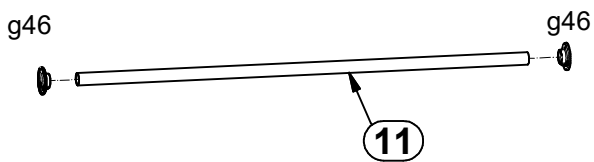
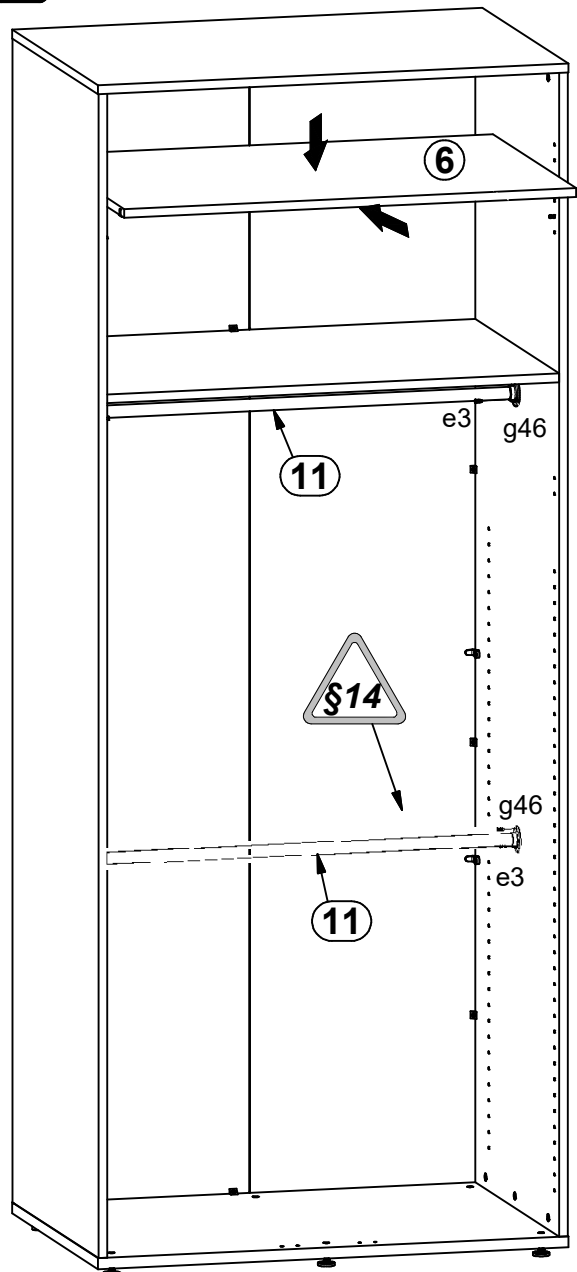

4A

4B

